

Date Installed: 7-15-04  
 Installed by: Randy Wyse  
 Inspected by: Rex Moll

1" copper w/c  
 4" storm sewer

Res # 1250  
 Indiana Ave.

Date Installed: 8-23-04  
 Installed by: Randy Wyse  
 Inspected by: Rex Moll  
 6" san.



Date Installed: 7-15-04  
 Installed by: Randy Wyse  
 Inspected by: Rex Moll

1" copper w/k  
 4" storm sewer

Res # 1250  
 Indiana Ave.

Date Installed: 9-23-04  
 Installed by: Randy Wyse  
 Inspected by: Rex Moll  
 6" SAN.

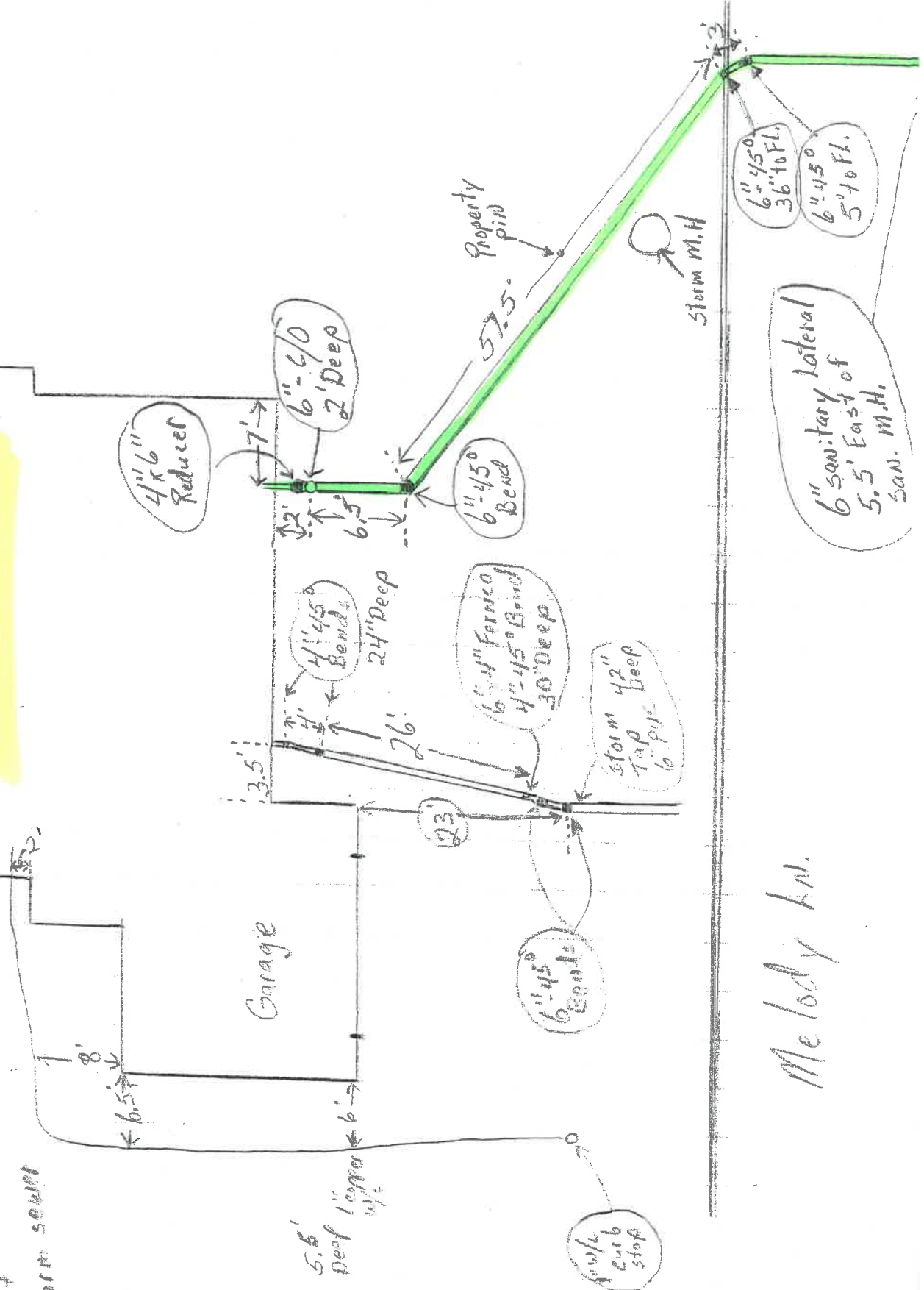

Melody Ln.

Date Installed: 7-15-04  
 Installed by: Randy Wyse  
 Inspected by: Rex Mott

1" copper w/ε

4" storm sewer

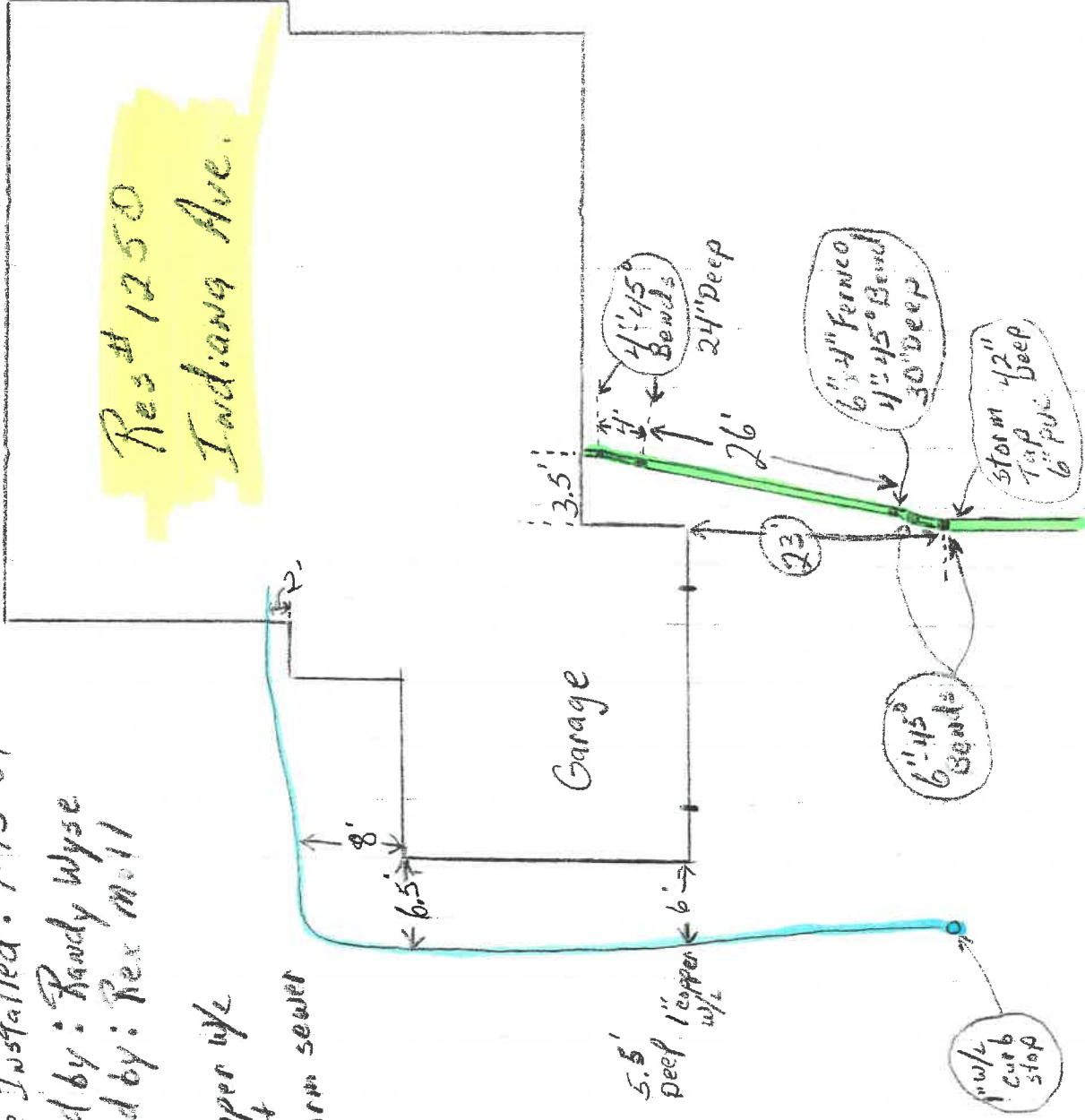

Melody LN.

Date Installed: 7-15-04  
Installed by: Randy Wyse  
Inspected by: Rex Mott

Res # 1250  
Indiana Ave.

1" copper w/c

4" storm sewer

Garage

5.5' Deep  
1" copper  
w/c

23'

24" Deep

6" 4" Fernco  
4" 45° Bend  
30" Deep

storm Tap  
42" Deep  
6" PVC

6" 45°  
Bends

1" w/c  
Curb  
stop

Melody Ln.

